



昆山国力真空电器有限公司

Kunshan GuoLi Vacuum Electric Co., Ltd.

Address: No.1418, Shuixiu Rd., Kunshan City, Jiangsu Province, China Postcode: 215316

Tel: +86-512-57735621 57772785 Fax: +86-512-57777020 Website: http://www.glvac.cn

TJ-1.14/200 Contactor used vacuum interrupter

Brief introduction:

The Interrupter adopts “one shut technology”, ceramic shell, CuWC as the contact material; is characterized by high insulation, low stop-flow, strong blowout ability, long life, small size etc, and has advantages as easy to maintain, no explosion risk, pollution-free and low noise etc. Contactors assembled by it are used to control and protect the electricity transmission and distribution system in electrical, mechanical, chemical, metallurgy, mining and railway department, especially in frequent operation fields.

Main technical specifications

Model	TJ-1.14/200
Rated Voltage (kV)	1.14
Rated Current (A)	200
Rated Make Current (kA/Times)	2/50
Rated Break Current (kA/Times)	1.6/50
Maximum Break Current (kA/Times)	4/3
Rated Short Time Withstand Current/Last Time (kA/s)	1.6/10
Break Times Under Rated Current (AC-4)	6×10^4
Short Time (1Min) Power Frequency Withstand Voltage (kV)	10
Thunder and Lighting Shock (kV)	
Circuit Resistance under Rated Contact Pressure ($\mu\Omega$)	≈ 120
Mechanical Life (Times)	1×10^6
Contact Force at Rated Contact Gap (N)	30 ± 5
Max Contact Gap (mm)	3
Reaction Force at Rated Contact Distance (N)	65 ± 10
Contact Erosion Limit (mm)	1
Weight (kg)	0.25
Store Duration (Year)	10
Mechanical Parameter	
Rated Contact Gap (mm)	2 ± 0.2
Contact Overtravel (mm)	1 ± 0.2
Average Break Speed (m/s)	0.3~0.5
Average Make Speed (m/s)	0.05~0.15
Rated Contact Operating Pressure (N)	90

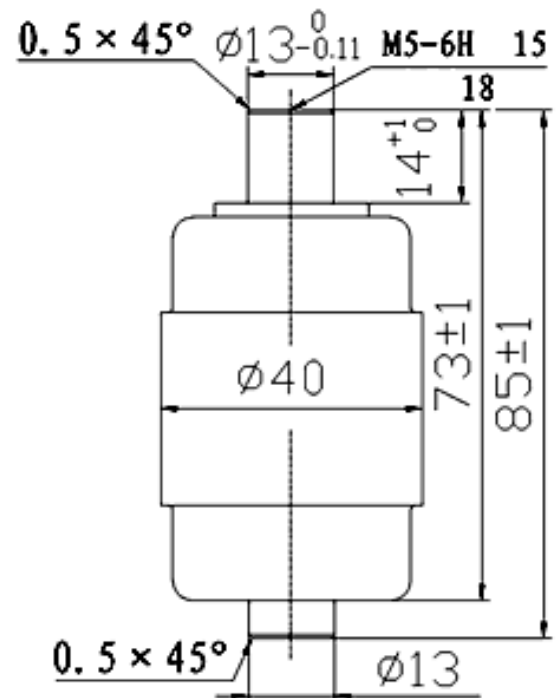

Contact Make Bounce Time (ms)	=3
Three-phase Synchronism (ms)	=1